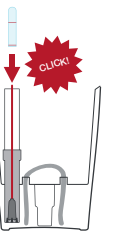
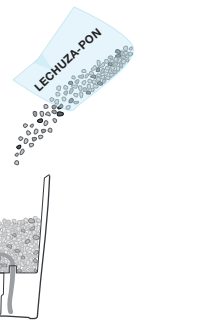
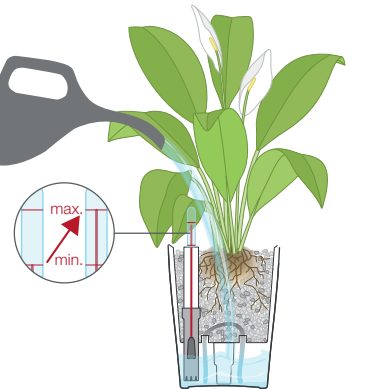

1**2****3****4****5****LECHUZA-PON****12L**
2.7 US.dry.gal.**25L**
5.7 US.dry.gal.

No. 19791

No. 19790

6L
1.4 US.dry.gal.*Lechuza*[®]

LECHUZA
geobra Brandstätter Stiftung & Co. KG
 Brandstätterstraße 2-10 . 90513 Zirndorf . GERMANY
Hotline: +49 911 9666-1660
E-Mail: info@lechuza.com
Internet: www.lechuza.com

© 2015 Made in Germany
 30810774 / 10.15 / P0522
 Printed in Germany

www.lechuza.com**MINI-DELTINI**

Planting and watering instructions | Pflanz- und Gießanleitung
 Instructions de plantation et d'arrosage | Instrucciones para la
 plantación y el riego | Istruzioni per piantare e irrigare
 Handleiding planten en gieten | Instruções para plantação e rega
 Instrukcja sadzenia i podlewania | Инструкция по посадке
 и поливу растений | Návod k pěstování a zalévání
 Istutus- ja kasteluohje | Planterings- och skötselavvisning
 Útsetési és öntözési javaslatok | Upute za sadnju i zalijevanje
 植え付けと水やりの手引き | 식재 및 급수 설명서
 种植和浇水指南 | تعليمات بخصوص الزراعة والسقي
 Návod na vysádzanie a polievanie | Dikim ve Sulama Talimatı
 Οδηγίες φύτευσης και ποτίσματος | הוראות שתילה והשקיה

Lechuza[®]